

STAR PRIDE

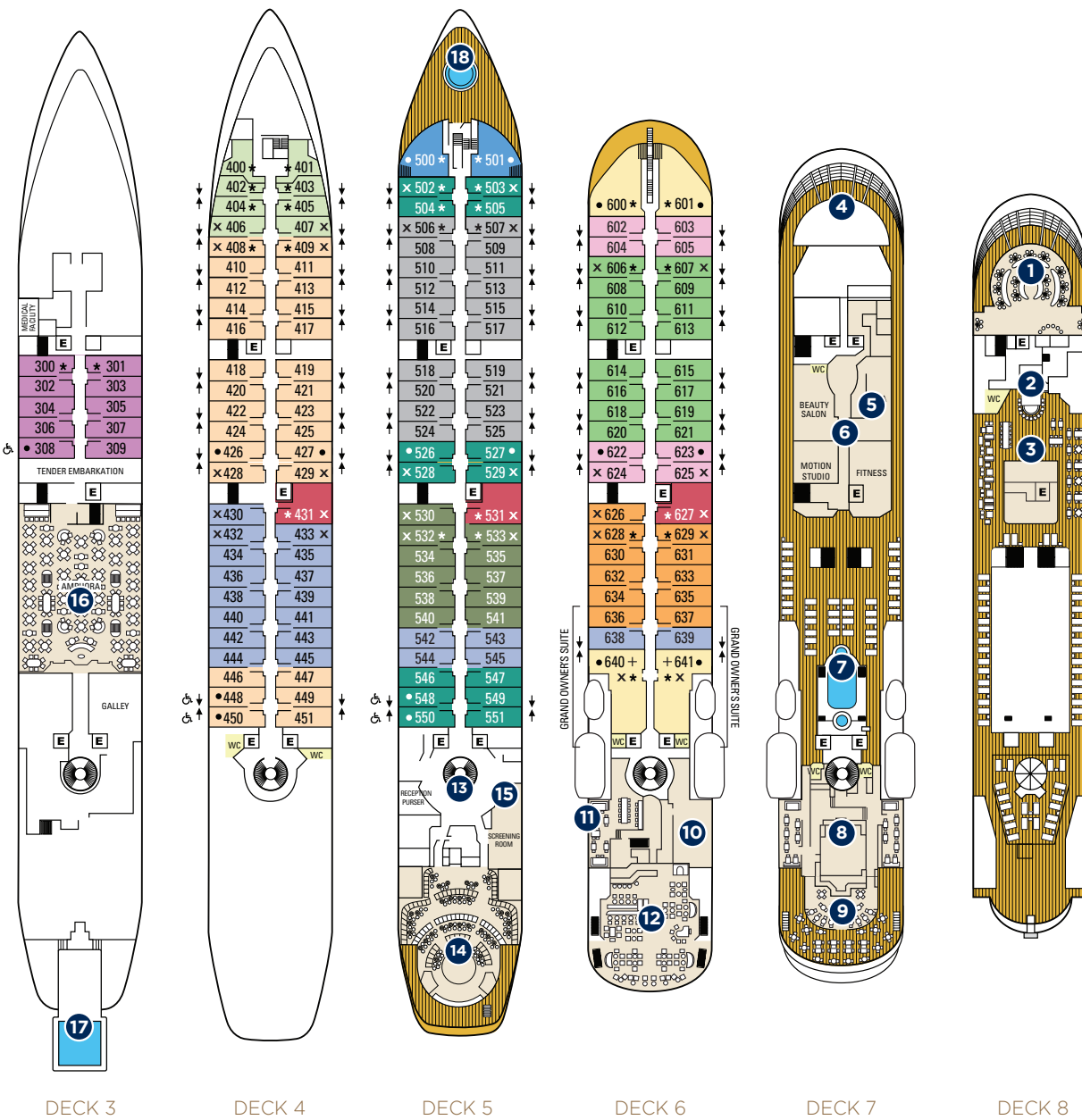

ONBOARD SPACES

- | | | |
|----------------------------------|----------------------|-------------------------|
| 1 Yacht Club Café & Library | 7 Pool and whirlpool | 14 Lounge |
| 2 Star Bar | 8 Courtyard | 15 Screening Room |
| 3 Star Barbecue | 9 Veranda/Candles | 16 AmphorA Restaurant |
| 4 Bridge | 10 Signature Shop | 17 Watersports Platform |
| 5 WindSpa | 11 Restaurant | 18 Whirlpool |
| 6 Fitness Center & Motion Studio | 12 Compass Rose | |
| | 13 Reception | |
- E = Elevator
WC = Public Restroom

- + RESTRICTED VIEW
 - ↑ ADJOINING SUITES
 - E ELEVATOR
 - * ALSO INCLUDES BATHTUB
 - ONE QUEEN SIZE BED ONLY (no twin option)
 - x 3RD BERTH AVAILABLE
- ♿ MODIFIED ACCESSIBLE SUITES
 - Feature a full-size bed (no twin option)
 - Suites 308, 448, 450, 548, & 550 are modified accessible, shower only with a small lip into shower, only one sink, a step into the bathroom with a portable ramp, standard interior and exterior doorways.

- Owner's Suite (OW)
- Classic Suite (CS)
- Deluxe Suite (DS)
- Star Balcony Suite (SBS1)
- Balcony Suite (BS1)
- Star Balcony Suite (SBS)
- Balcony Suite (BS)
- Ocean View Suite (S3)
- Ocean View Suite (S2)
- Star Ocean View Suite (SS1)
- Ocean View Suite (S1)
- Ocean View Suite (S)
- Star Porthole Suite (SP)

- Access to board ship is via stairs only.
- Access to/from outside deck may require assistance with doors and thresholds.



GRAND OWNER'S SUITE



OWNER'S SUITE MIDSHIP

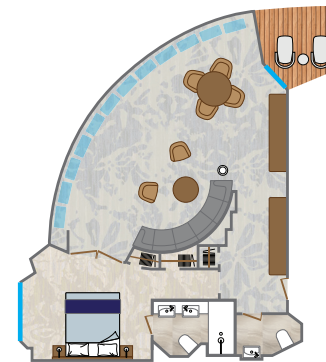

OWNER'S SUITE FORWARD

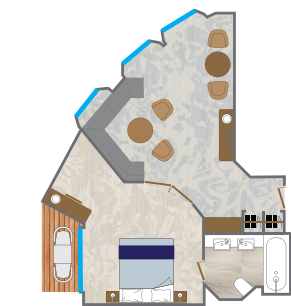

CLASSIC SUITE



DELUXE SUITE



STAR PORTHOLE SUITE



STAR BALCONY SUITE

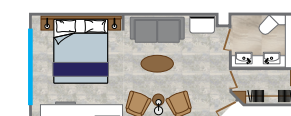

STAR OCEAN VIEW SUITE



BALCONY SUITE



OCEAN VIEW SUITE

SHIP FACTS

- GUEST CAPACITY: 312
- GUEST DECKS: 6
- CREW MEMBERS: 188-190
- LENGTH: 522 feet (159 meters)
- BEAM: 62 feet (19 meters)
- DRAFT: 17.7 feet (5.4 meters)
- CRUISING SPEED: 15 knots
- PROPULSION: Twin propeller, driven by two Wärtsilä diesel engines
- TONNAGE: 12,995 gross registered tons (grt)
- SHIP'S REGISTRY: Bahamas

ALL-SUITE SHIP

- Grand Owner's Suites, 3 Bedroom Suites, 640/638/636 or 641/639/637: 1,374 square feet (128 square meters)
- Can also be booked as 2 Bedroom Suites, 640/638 or 641/639: 1,097 square feet (102 square meters)
- Owner's Suites Midship, 640 and 641 (OW): 820 square feet (76 square meters), both with 3rd berths
- Owner's Suites Forward, 600 and 601 (OW): 575 square feet (54 square meters)

- Classic Suites, 500 and 501 (CS): 400 square feet (37 square meters)
- Deluxe Suites, 431, 531, 627 (DS): 464 square feet (43 square meters), all with 3rd berths. Cabin 431 has two picture windows, excludes balcony
- Star Balcony Suites (SBS, SBS1): 277 square feet (26 square meters)
- Star Balcony Suites with 3rd berths – 530, 532, 533, 626, 628, 629

- Balcony Suites (BS, BS1): 277 square feet (26 square meters)
- Balcony Suites with 3rd berths – 506, 507, 606, 607
- Star Ocean View Suites (SS1): 277 square feet (26 square meters)
- Star Ocean View Suites with 3rd berths – 430, 432, 433

- Ocean View Suites (S, S1, S2, S3): 277 square feet (26 square meters)
- Ocean View Suites with 3rd berths – 406, 407, 408, 409, 428, 429, 502, 503, 528, 529, 624, 625

- Star Porthole Suites (SP): 277 square feet (26 square meters)